

6 5 4 3 2 1

D

C

B

A

D

C

B

A

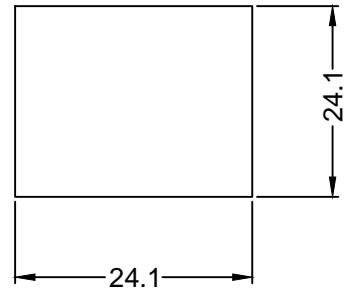
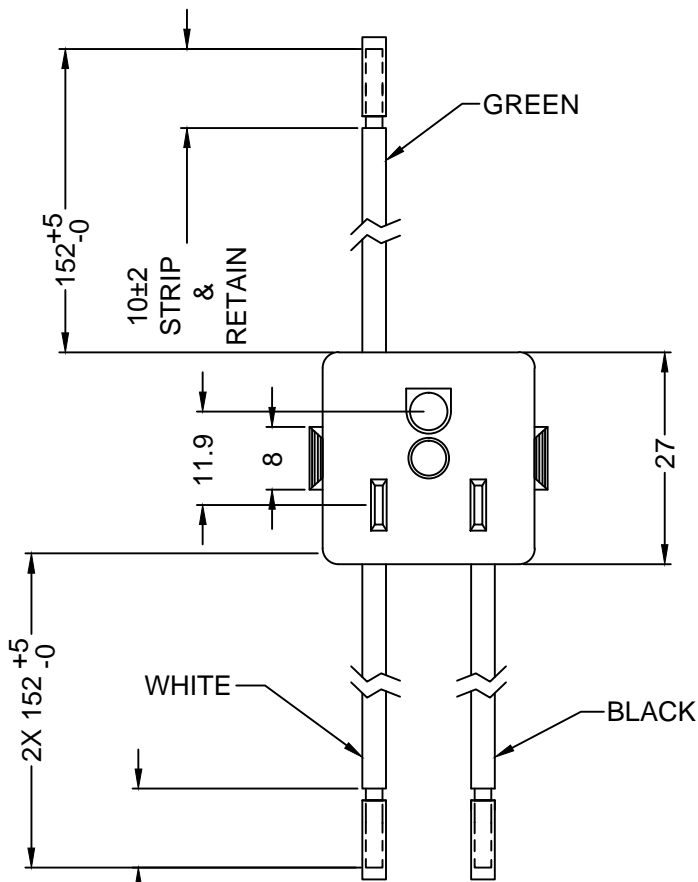

PANEL CUTOUT

MATERIAL:
 Housing: Thermoplastic, UL-94-V2 rated, color black
 Contacts: Brass
 Clips: Steel, corrosion resistant
 Wires: Black & White: 14AWG, UL 1015, 105°C, 600V, VW-1
 Green: 16 AWG, UL 1015, 105°C, 600V, VW-1

ELECTRICAL SPECIFICATIONS:
 Rated Current: 15 AMPS
 Rated Voltage: 125 VAC

MECHANICAL SPECIFICATIONS:
 Panel thickness: 0.8mm ~ 2.0mm

ENVIRONMENTAL SPECIFICATIONS:
 Operating temperature: -40°C ~ +60°C

RoHS
COMPLIANT

SAFETY APPROVALS: US

REVISIONS			
REV	DATE	CHANGE	CHNG CHECK APPR
A	7/2/17	SNAP INCLIP FROM 32.6 TO 29.8	PB

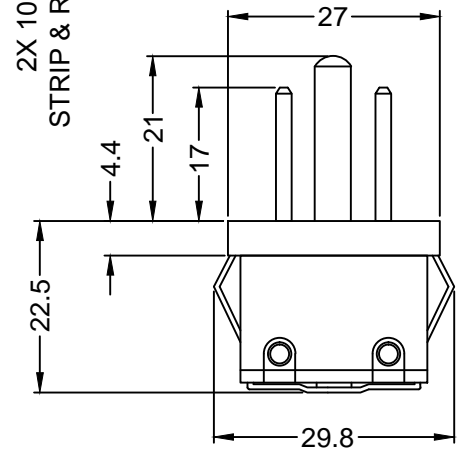

TOLERANCE UNLESS OTHERWISE SPECIFIED	
X	± 1
X.X	± 0.4
X.XX	± 0.13
DRAWN BY	PB
CHECK BY	
APPR BY	
DATE:	9/7/12

Power Dynamics, Inc.
 Phone: 973 560-0019 Whippany, New Jersey Fax: 973 560-0076

PART: NEMA 5-15P SNAP IN PANEL MOUNT PLUG WITH 152mm LONG WIRES STRIP & RETAIN

PART #: **PD-515P-SW**

SIZE: A
SCALE: NTS

ALL DIMENSIONS FOR REFERENCE ONLY
DIMENSIONS ARE IN MILLIMETERS

SHEET 1 of 1
REV: A

6 5 4 3 2 1